

# 1200 19TH STREET NW

WASHINGTON, DC

971 - 4,053 SF AVAILABLE





RAPPAPORT



**1200 19TH STREET NW**  
**WASHINGTON, DC**

Outdoor seating and blade signage available at this highly visible streetfront retail space facing M Street. The property benefits from high pedestrian traffic with a Walk Score of 96. Located in the vibrant Golden Triangle neighborhood with a variety of national and local tenants, the property is a short walk to multiple hotels including the St. Gregory, The Washington Marriott, The Ritz Carlton and The Renaissance Washington.

**DEMOGRAPHICS 2024**

	0.25 MILE	0.5 MILE	1 MILE
 <b>POPULATION</b>	3,188	17,312	74,489
 <b>DAYTIME POPULATION</b>	56,421	179,530	356,257
 <b>HOUSEHOLD INCOME</b>	\$120,258	\$139,498	\$152,472
 <b>TRAFFIC COUNTS</b>	12,600 on 19th Street NW		

**AREA RETAILERS**

**TAYLOR**  
GOURMET

J<sup>O</sup>S. A. BANK





1200 19TH STREET NW  
WASHINGTON, DC





## SITE PLAN

1200 19TH STREET NW | WASHINGTON, DC

971 - 4,053 SF AVAILABLE

M STREET NW 21,800 VPD

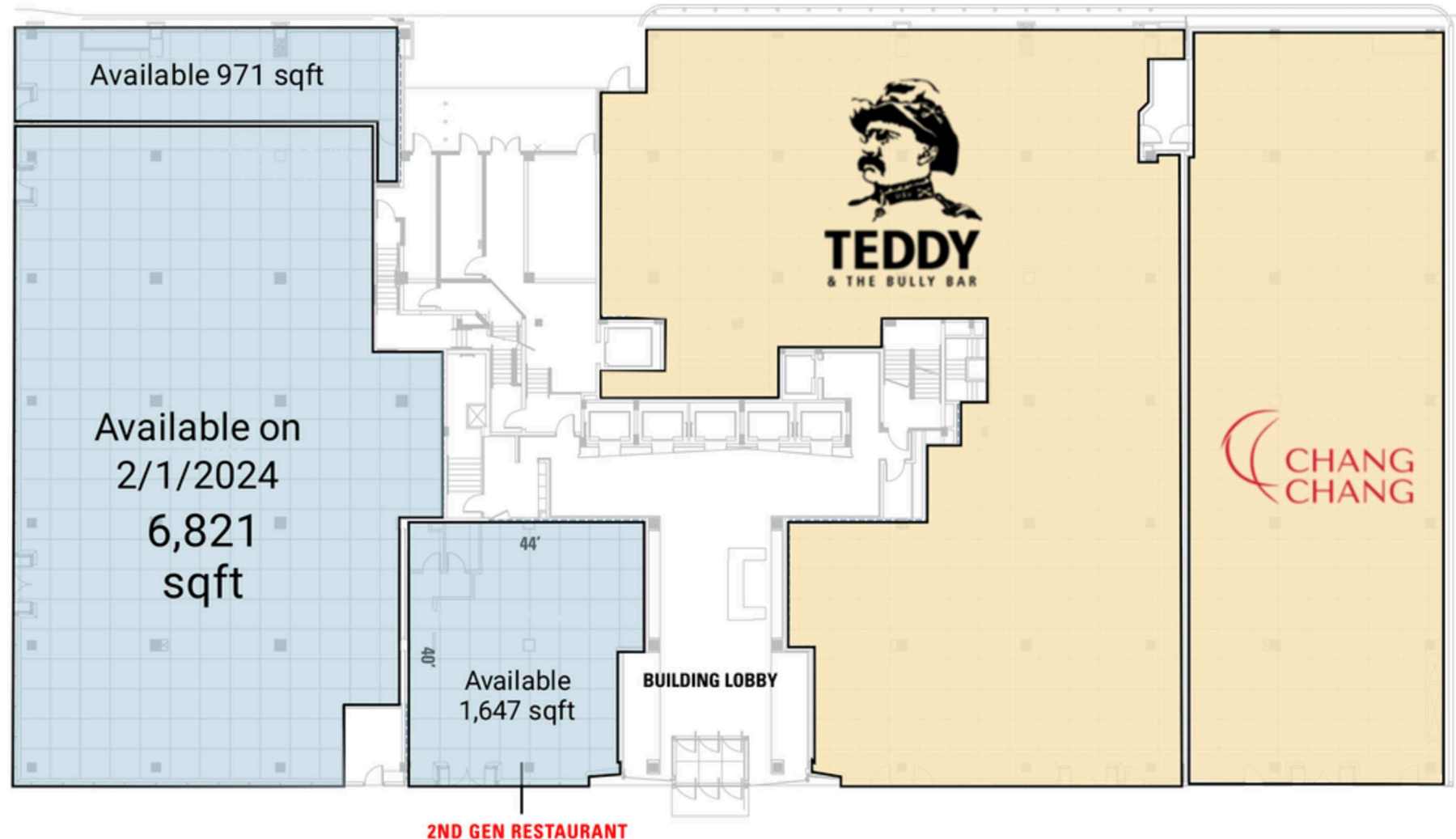

19TH STREET NW 12,600 VPD

**1200 19TH STREET NW | WASHINGTON, DC**

**1200 19TH STREET NW | WASHINGTON, DC**



**1200 19TH STREET NW**  
**WASHINGTON, DC**

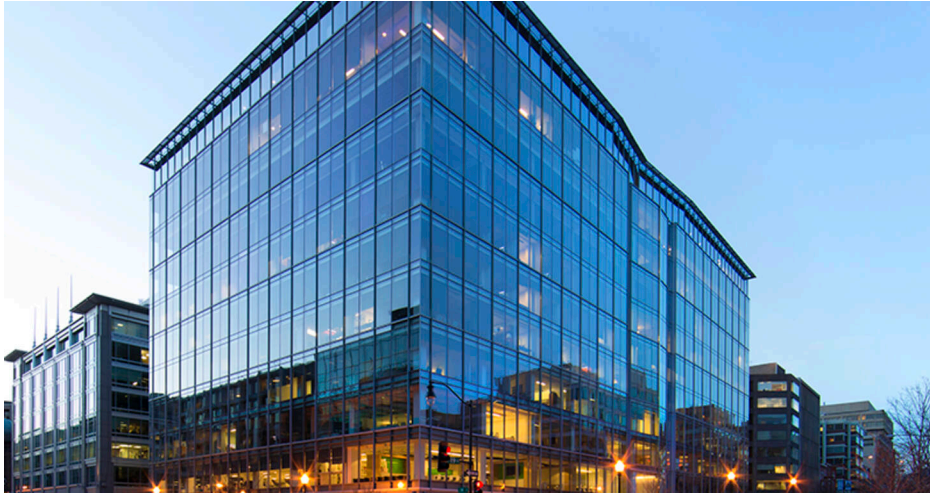

# RAPPAPORT

**1200 19TH STREET NW | 1200 19TH STREET NORTHWEST, WASHINGTON, DC**

**Kyle Gamber | [kgamber@rappaportco.com](mailto:kgamber@rappaportco.com) | 571.382.1216**

**Bill Dickinson | [bdickinson@rappaportco.com](mailto:bdickinson@rappaportco.com) | 703.310.6983**

**[rappaportco.com](http://rappaportco.com)**