



RAPID RAPPORT





TYSONS, VA

2,136 - 48,748 SF AVAILABLE

TYSONS WEST TYSONS, VA

Ideally situated at the intersection of ease and convenience, Tyson's West is a mixed use center that provides the retail and medical needs for the sophisticated professionals and residents of Tyson's Corner. Tyson's West boosts extraordinary traffic counts with 72,000+ vehicles travel on Leesburg Pike (Rt. 7), between the Dulles Airport Access Road and Chain Bridge Road (Rt. 123).

DEMOGRAPHICS 2024

		1 MILE	3 MILES	5 MILES
	POPULATION	14,442	85,104	229,444
	DAYTIME POPULATION	52,553	101,219	183,101
	HOUSEHOLD INCOME	\$186,253	\$241,051	\$231,053
	TRAFFIC COUNTS	61,000 on Route 7		

CO-TENANTS











SITE PLAN

TYSONS WEST | TYSONS, VA

2,136 - 48,748 SF AVAILABLE

LEVEL 1



LEVEL 2

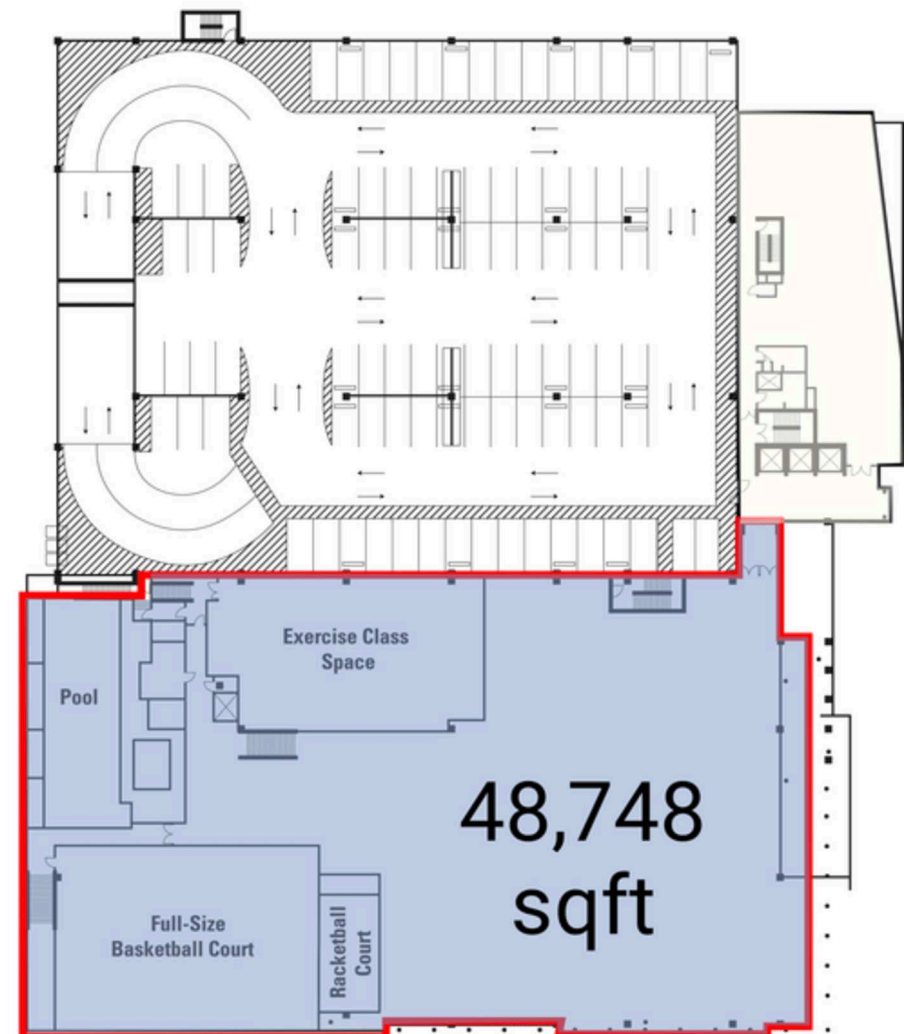

TYSONS WEST
TYSONS, VA

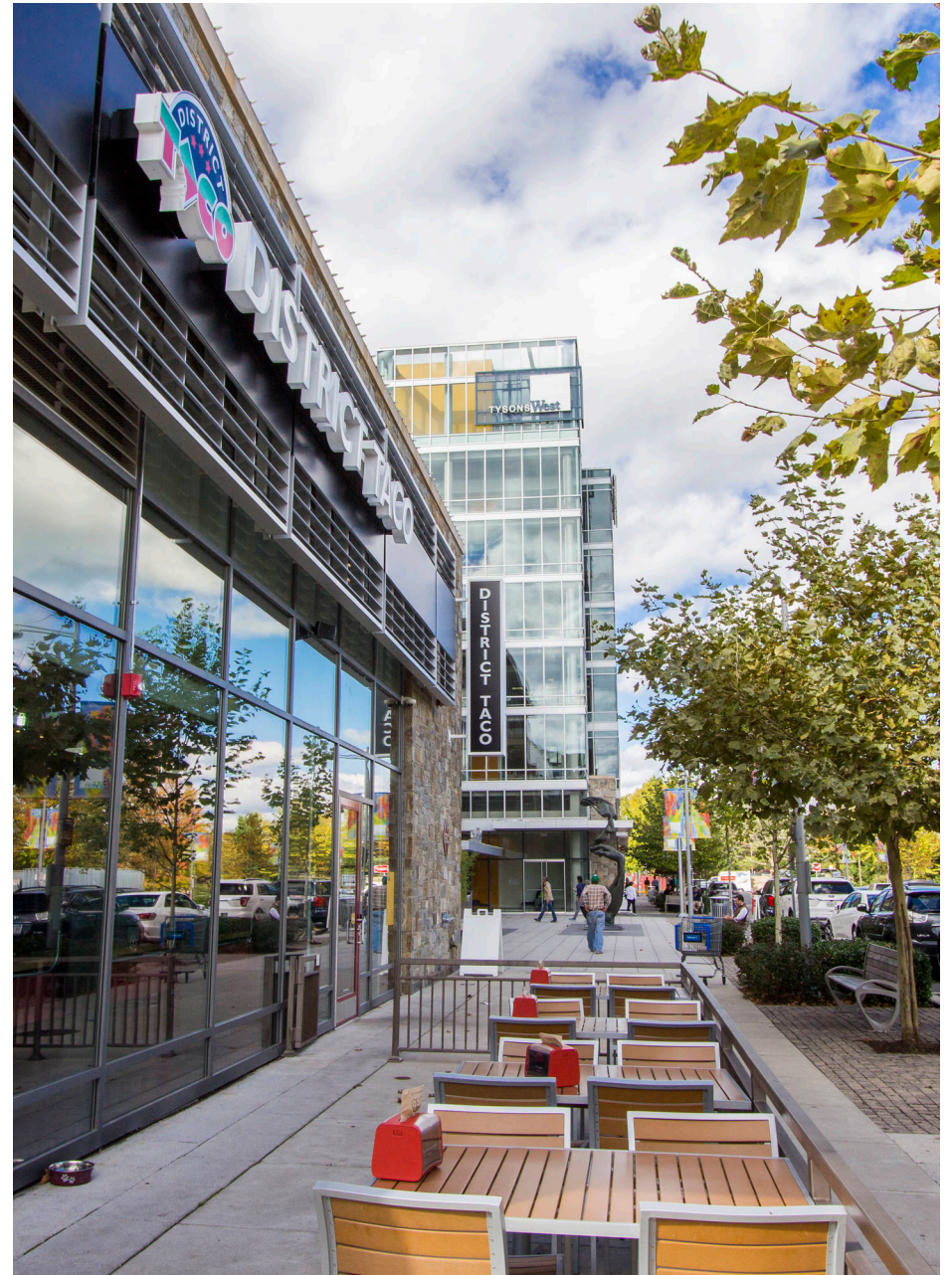

RAPPAPORT

TYSONS WEST | 1500 CORNERSIDE BLVD, TYSONS, VA

Jim Farrell | jfarrell@rappaportco.com | 571.382.1229

Christian Kingston | ckingston@rappaportco.com | 571.382.1255

rappaportco.com