

CANAL PARK

WASHINGTON, DC

RAPPAPORT





CANAL PARK

WASHINGTON, DC

Second generation restaurant space available in Canal Park, a local gathering spot in a growing office and residential neighborhood. The site is surrounded by new development and has dense daytime demographics. Canal Park hosts dozens of community events throughout the year including a fountain feature in the summer and skating rink in the winter located just outside of the space. Two blocks from Navy Yard Metro Station and just blocks from Nationals Park.

DEMOGRAPHICS 2024

	.5 MILE	1 MILE	2 MILES
 POPULATION	8,743	36,469	124,114
 DAYTIME POPULATION	11,108	36,788	205,140
 MEDIAN HOUSEHOLD INCOME	\$134,008	\$129,009	\$110,799

CO-TENANTS





CAVA

Mezzo Grill











SITE PLAN

CANAL PARK | WASHINGTON, DC

CANAL PARK
WASHINGTON, D.C.
3,500 SF



MAIN FLOOR
2,500 SF

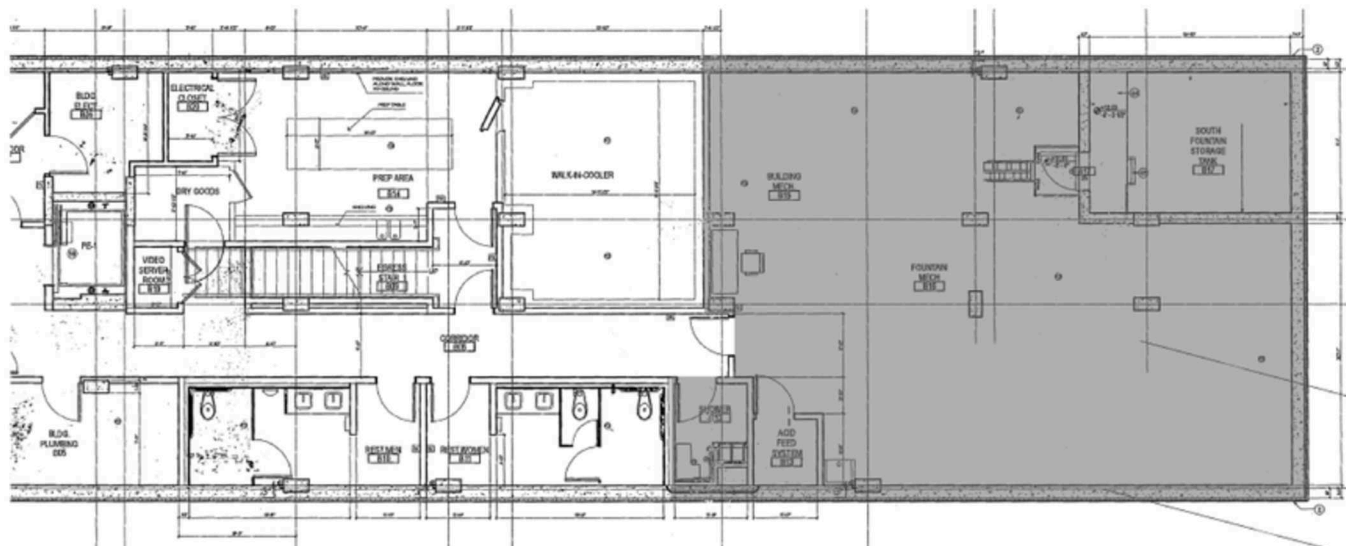

BASEMENT FLOOR
1,000 SF

SEASONAL PLAN

CANAL PARK | WASHINGTON, DC

CANAL PARK - AN ACTIVE ENVIRONMENT

WASHINGTON, D.C.

WINTER:
ICE-SKATING



SUMMER:
FOUNTAIN



PLAN 3

CANAL PARK | WASHINGTON, DC

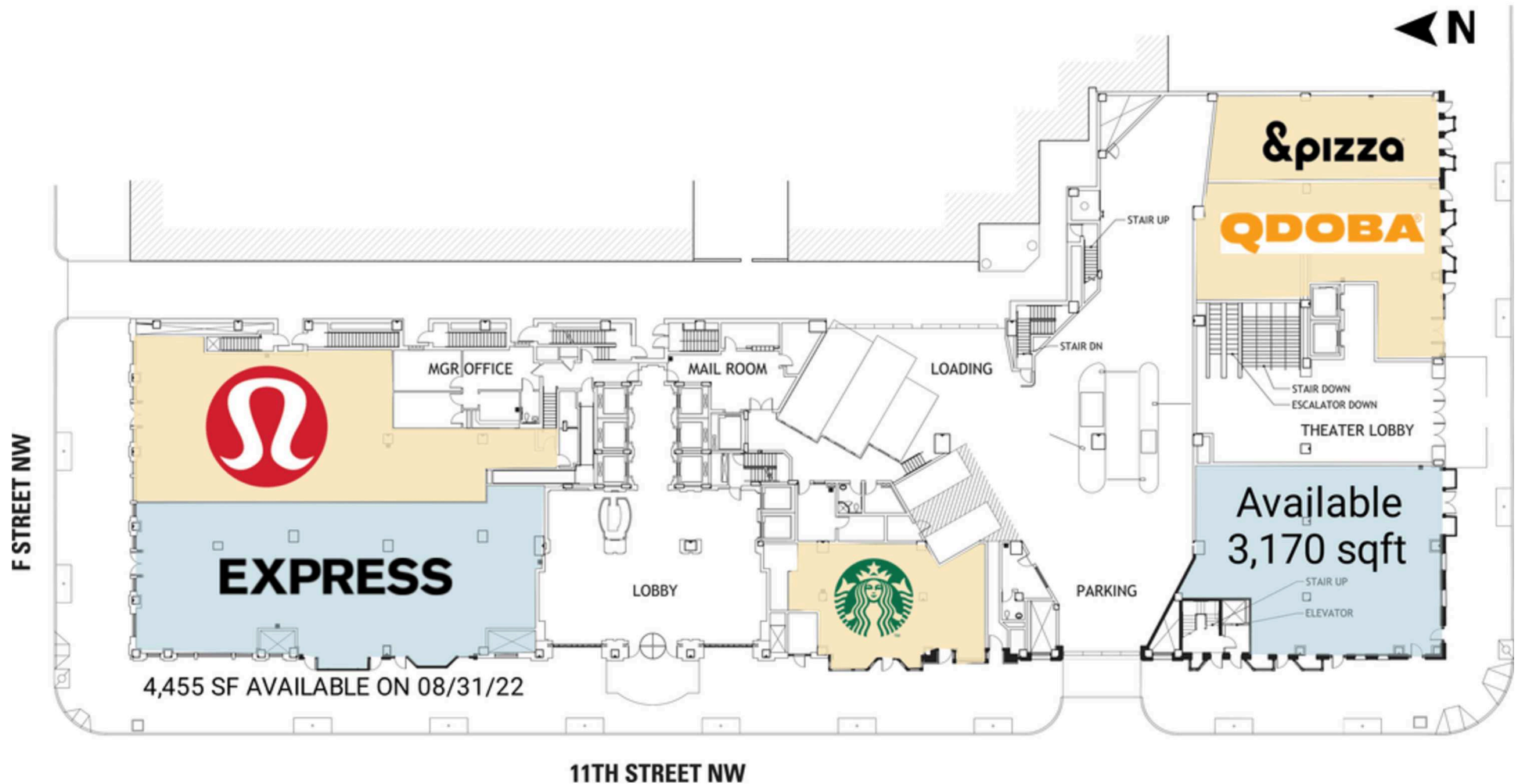

PLAN 4
CANAL PARK | WASHINGTON, DC

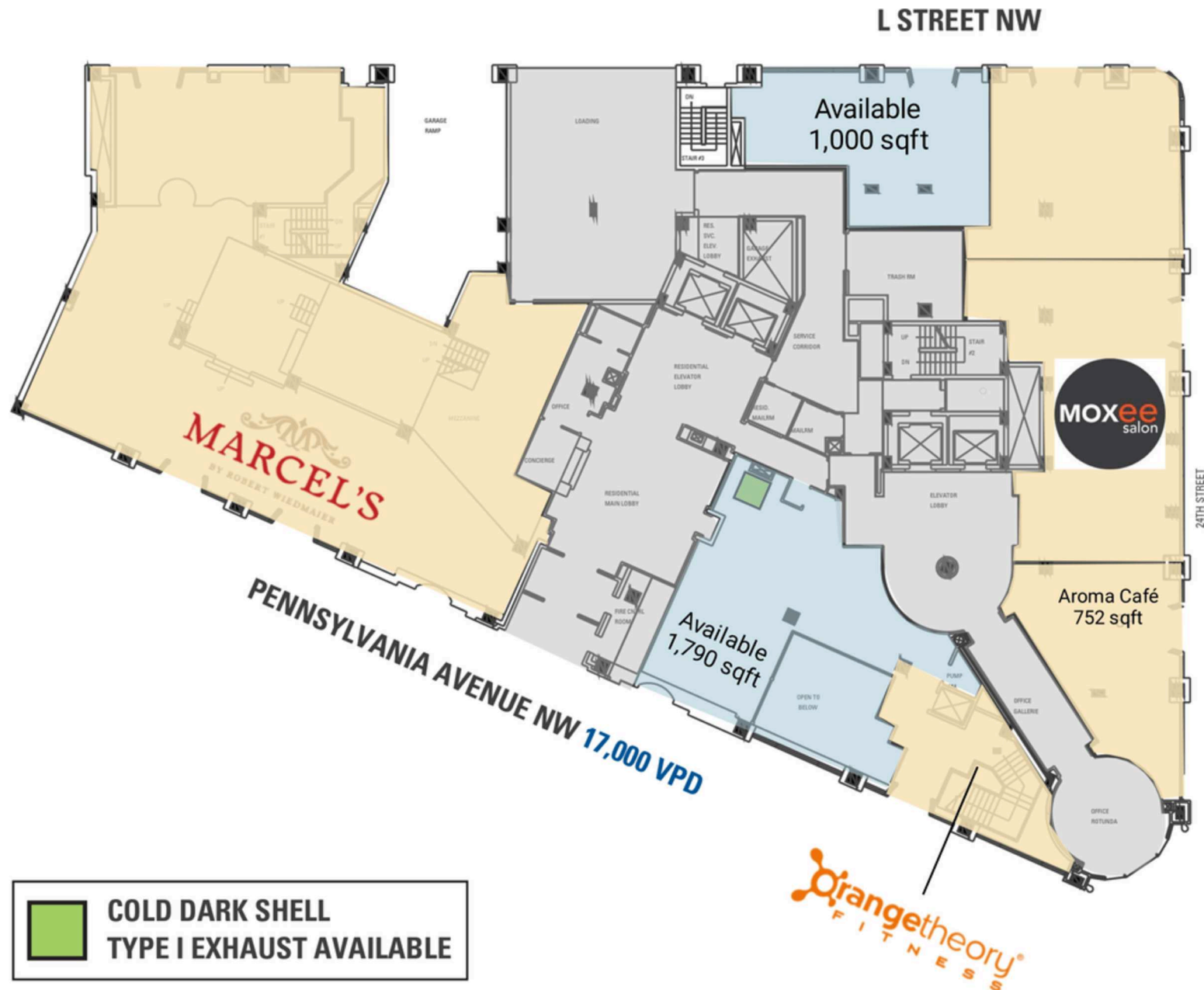

CANAL PARK
WASHINGTON, DC



RAPPAPORT

CANAL PARK | 200 M ST SE, WASHINGTON, DC

Kyle Gamber | kgamber@rappaportco.com | 571.382.1216

Bill Dickinson | bdickinson@rappaportco.com | 703.310.6983

rappaportco.com