

# GALLERY COURT

WASHINGTON, DC

1,747 - 2,775 SF AVAILABLE





RAPPAPORT



## GALLERY COURT WASHINGTON, DC

Located one block from the city's transit hub, the Gallery Place/Chinatown Metro station, Gallery Court occupies the busiest corner in Washington, DC. This golden compass offers some of the highest daily views and foot traffic opportunities of any commercial property in the nation's capital, seven days per week and 18 hours per day. Three beautiful row-home buildings offer storefronts along 7th and H Streets, front-and-center in historic Chinatown. With the ability to split or combine space among the three buildings, restaurants and shops at Gallery Court have a golden opportunity to serve a global customer base in the most popular neighborhood in Washington, D.C.

### DEMOGRAPHICS 2024

	0.25 MILE	0.5 MILE	1 MILE
 <b>POPULATION</b>	3,151	17,277	49,217
 <b>DAYTIME POPULATION</b>	34,485	101,982	306,839
 <b>HOUSEHOLD INCOME</b>	\$157,266	\$123,670	\$49,217
 <b>TRAFFIC COUNTS</b>	13,900 on 7th Street		

### AREA RETAILERS



**GALLERY COURT**  
WASHINGTON, DC



FIRST FLOOR RETAIL  
GALLERY COURT | WASHINGTON, DC  
1,747 - 2,775 SF AVAILABLE

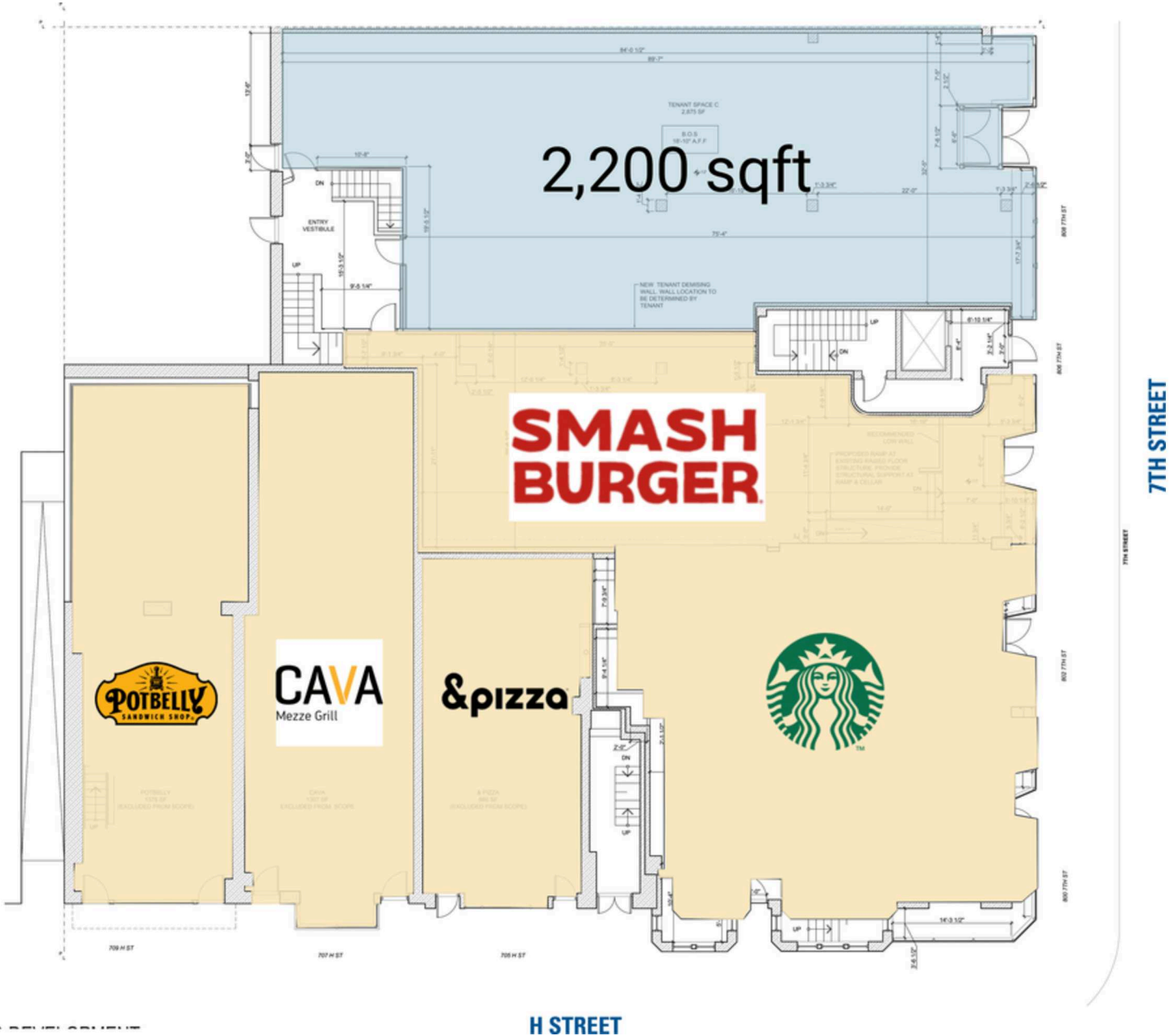

## SECOND FLOOR RETAIL

GALLERY COURT | WASHINGTON, DC

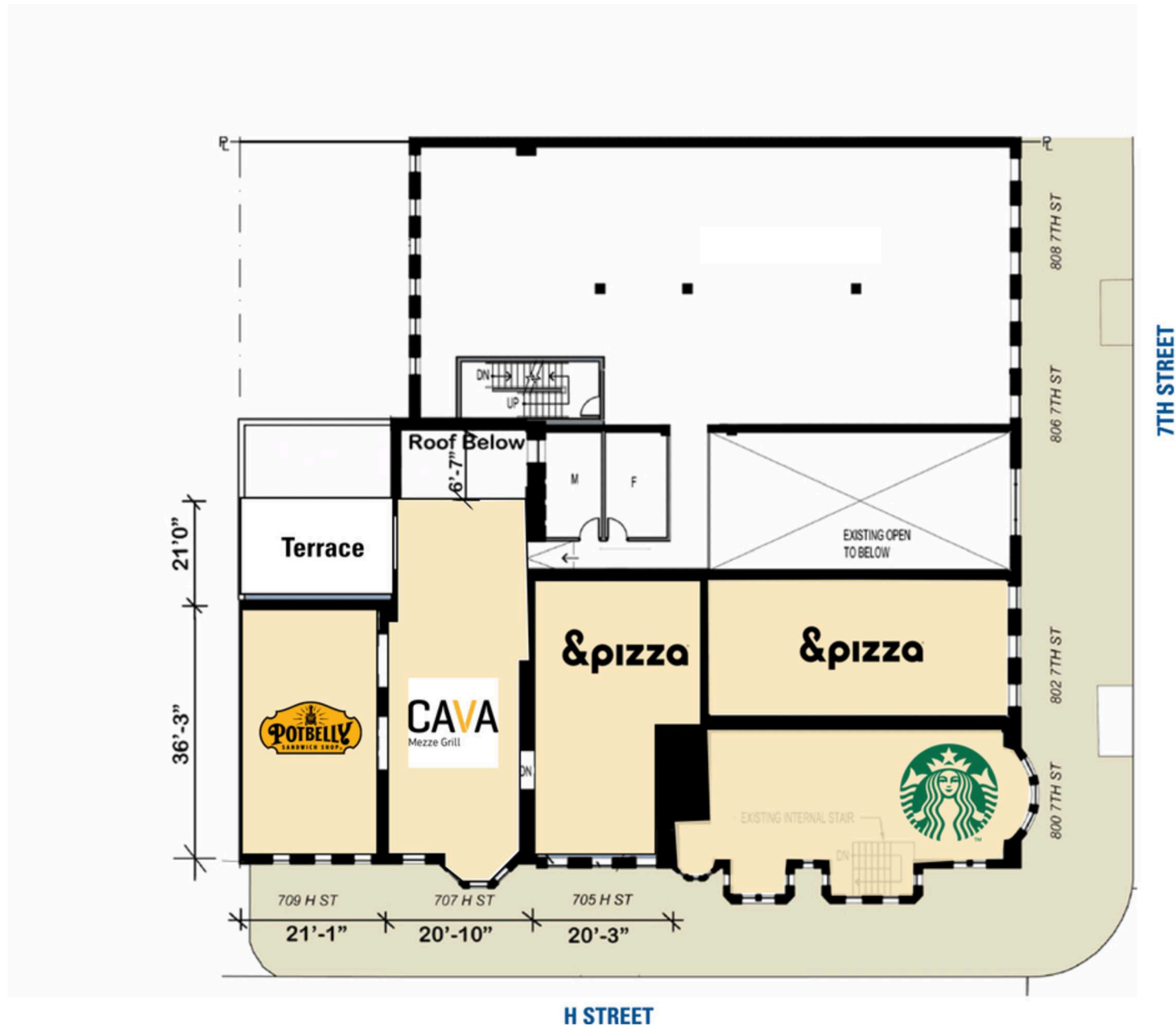

**BASEMENT FLOOR RETAIL**  
GALLERY COURT | WASHINGTON, DC



## GALLERY COURT WASHINGTON, DC



# RAPPAPORT

**GALLERY COURT | 802 7TH STREET NORTHWEST, WASHINGTON, DC**

**Bill Dickinson | [bdickinson@rappaportco.com](mailto:bdickinson@rappaportco.com) | 703.310.6983**

**Michael Howard | [mhoward@rappaportco.com](mailto:mhoward@rappaportco.com) | 571.382.1219**

**[rappaportco.com](http://rappaportco.com)**