

**4825 MARK CENTER DRIVE**  
**ALEXANDRIA, VA**

RAPPAPORT









4825 MARK CENTER DRIVE  
ALEXANDRIA, VA

Home to the 1.4M-square-foot Department of Defense Campus, Mark Center is exceptionally positioned in the heart of West Alexandria. Surrounded by 3.25M square feet of office, a Hilton hotel, 80K square feet of retail, and multiple apartment communities, this unrivaled daycare opportunity caters to a densely populated professional and residential region through ample on-site parking, easy access to I-395 and Seminary Road, as well as a transit station just steps away with connections to Van Dorn, King Street, Braddock Road, and Pentagon stations.

DEMOGRAPHICS 2024

	1 MILE	3 MILES	5 MILES
 POPULATION	41,602	251,411	576,918
 DAYTIME POPULATION	32,645	186,886	603,268
 HOUSEHOLD INCOME	\$104,217	\$124,231	\$145,213
 TRAFFIC COUNTS	58,000 on Seminary Road		

AREA RETAILERS





**SITE PLAN**

4825 MARK CENTER DRIVE | ALEXANDRIA, VA

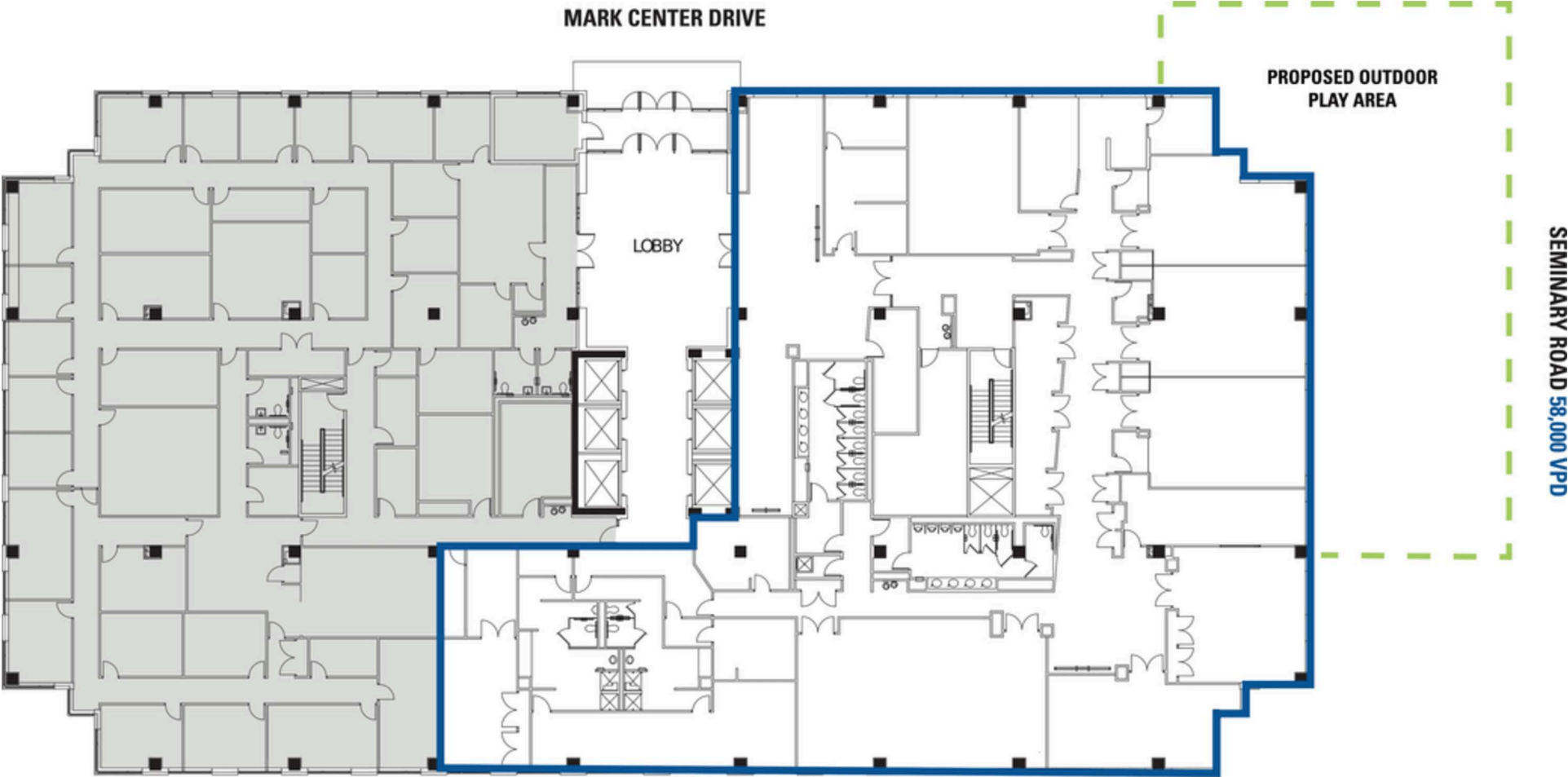



**4825 MARK CENTER DRIVE**  
**ALEXANDRIA, VA**



# RAPPAPORT

**4825 MARK CENTER DRIVE | 4825 MARK CENTER DRIVE, ALEXANDRIA, VA**

**Bill Dickinson | [bdickinson@rappaportco.com](mailto:bdickinson@rappaportco.com) | 703.310.6983**

**Melissa Webb | [mwebb@rappaportco.com](mailto:mwebb@rappaportco.com) | 571.382.1227**

**[rappaportco.com](http://rappaportco.com)**