

528 H STREET NE

WASHINGTON, DC

1,000 - 1,125 SF AVAILABLE





RAPPAPORT



528 H STREET NE
WASHINGTON, DC

Nestled in the heart of Washington, D.C.'s artsy and eclectic H Street Corridor, this two-story retail opportunity is prominently displayed on the corner of H and 6th Streets. Considered one of the fastest growing neighborhoods within the district, many new and trendy apartment communities, such as Anthology, Union Place and The Apollo, are within walking distance to this 2,250 SF brick-laden street corner space.

DEMOGRAPHICS 2024

	.25 MILE	.5 MILE	1 MILE
 POPULATION	6,815	15,860	59,739
 DAYTIME POPULATION	2,819	17,685	68,889
 HOUSEHOLD INCOME	\$126,780	\$133,196	\$130,947
 TRAFFIC COUNTS	15,000 on H Street NE		

CO-TENANTS



SITE PLAN

528 H STREET NE | WASHINGTON, DC
1,000 - 1,125 SF AVAILABLE

H STREET NE 15,000 VPD

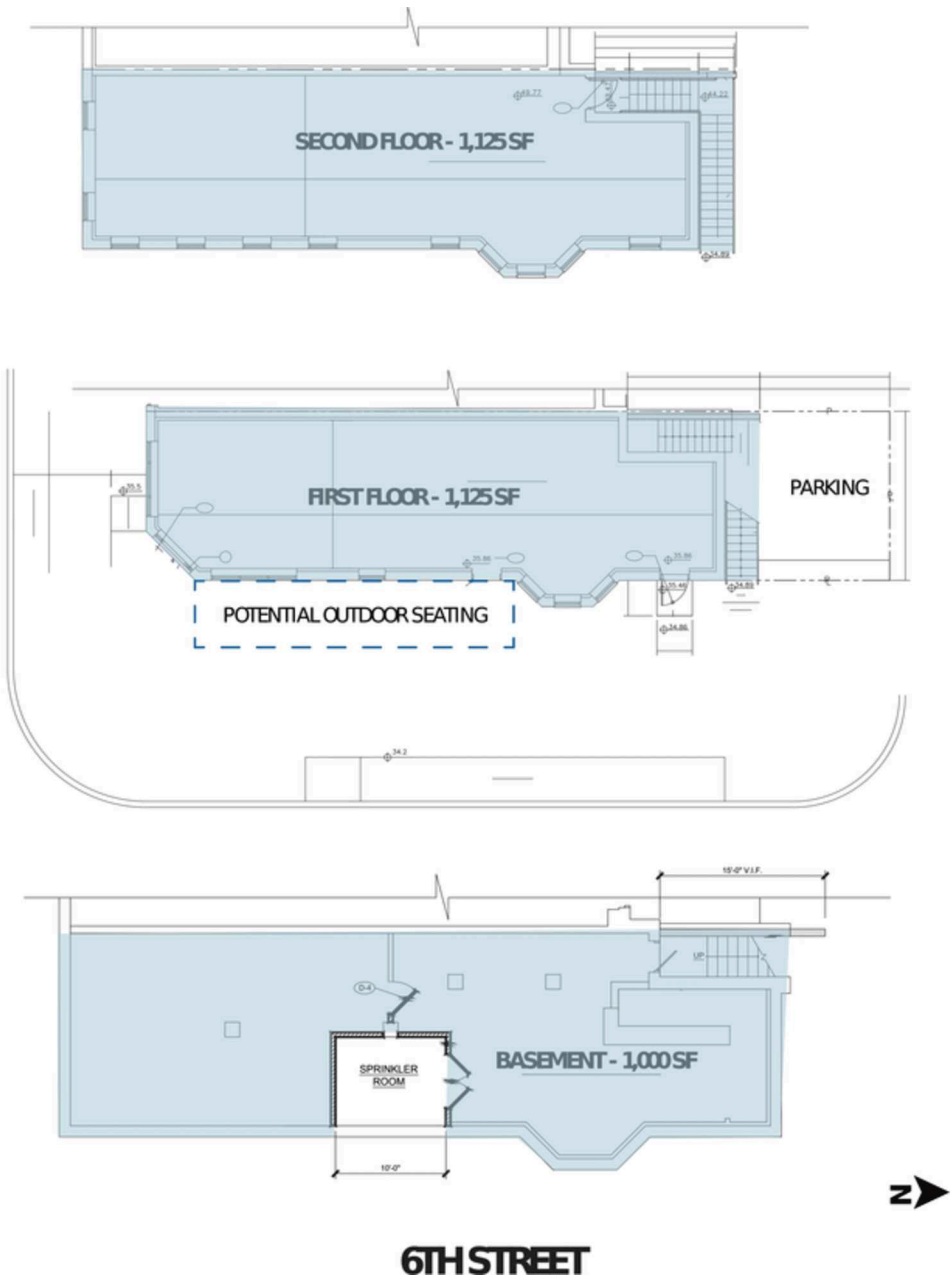

528 H STREET NE
WASHINGTON, DC

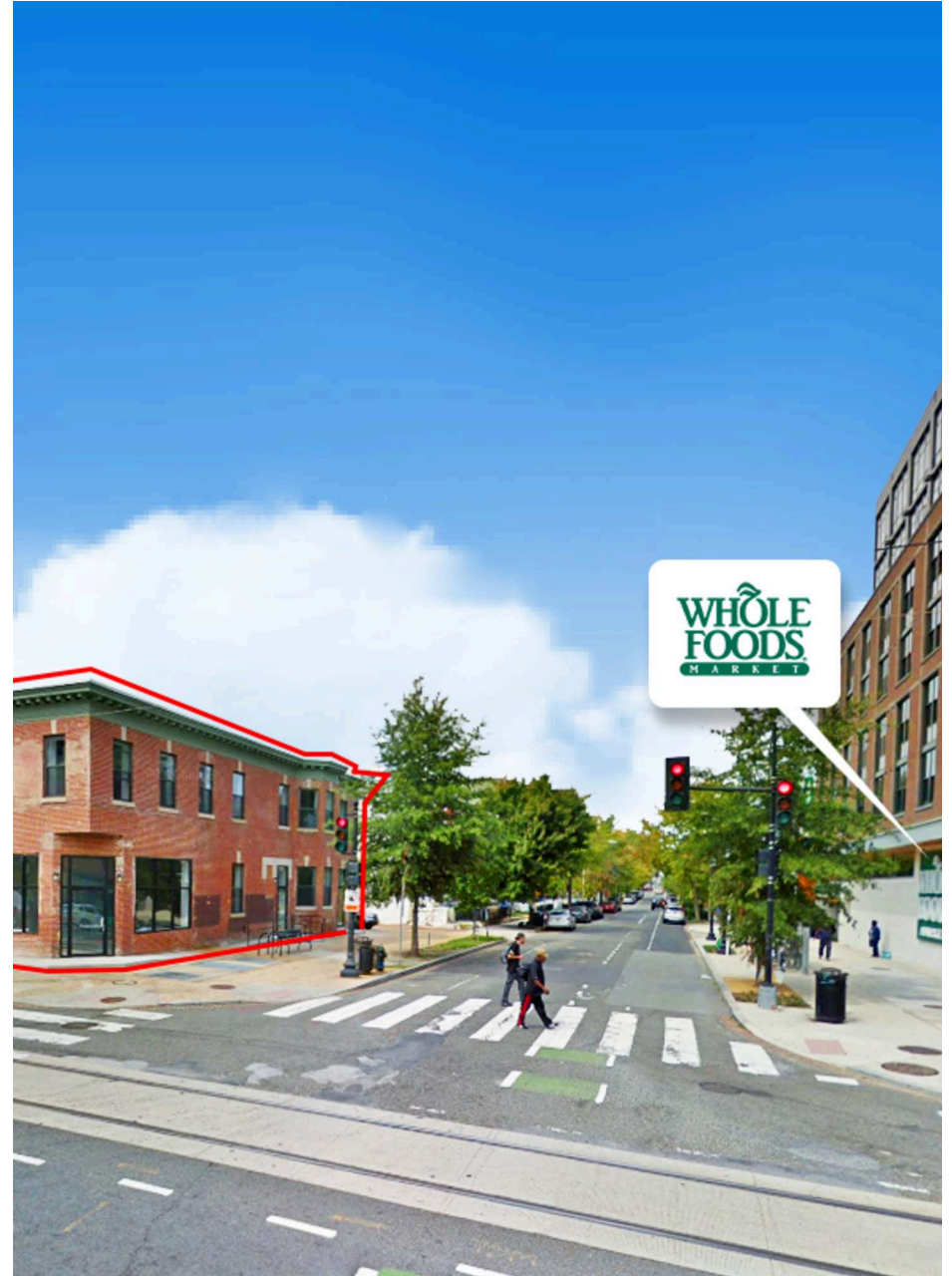

RAPPAPORT

528 H STREET NE | 528 H STREET NE, WASHINGTON, DC

Bill Dickinson | bdickinson@rappaportco.com | 703.310.6983

Patrick O'Meara | pomeara@rappaportco.com | 571.382.1218

rappaportco.com