



RAPID RAPPORT





FALLS CHURCH, VA
2,800 - 13,500 SF AVAILABLE

BROAD AND WASHINGTON

FALLS CHURCH, VA

Retail space available in Downtown Falls Church's core entertainment area. Broad and Washington is an enduring mixed-use building that celebrates, showcases and supports the local cultural and community activities that make the City of Falls Church a vibrant, engaging and special place to live. The project offers exciting restaurant and retail space on the ground floor and rooftop. Join Creative Cauldron community theater in a vibrant project with ideal space for an upscale casual restaurant, bakery, specialty grocer and soft goods retailers.

DEMOGRAPHICS 2024

	1 MILE	3 MILES	5 MILES
 POPULATION	21,694	168,806	496,171
 DAYTIME POPULATION	13,428	70,617	294,155
 HOUSEHOLD INCOME	\$167,023	\$159,141	\$145,097
 TRAFFIC COUNTS	26000 on Washington Street		

CO-TENANTS



SPACE PLAN

BROAD AND WASHINGTON | FALLS CHURCH, VA

2,800 - 13,500 SF AVAILABLE

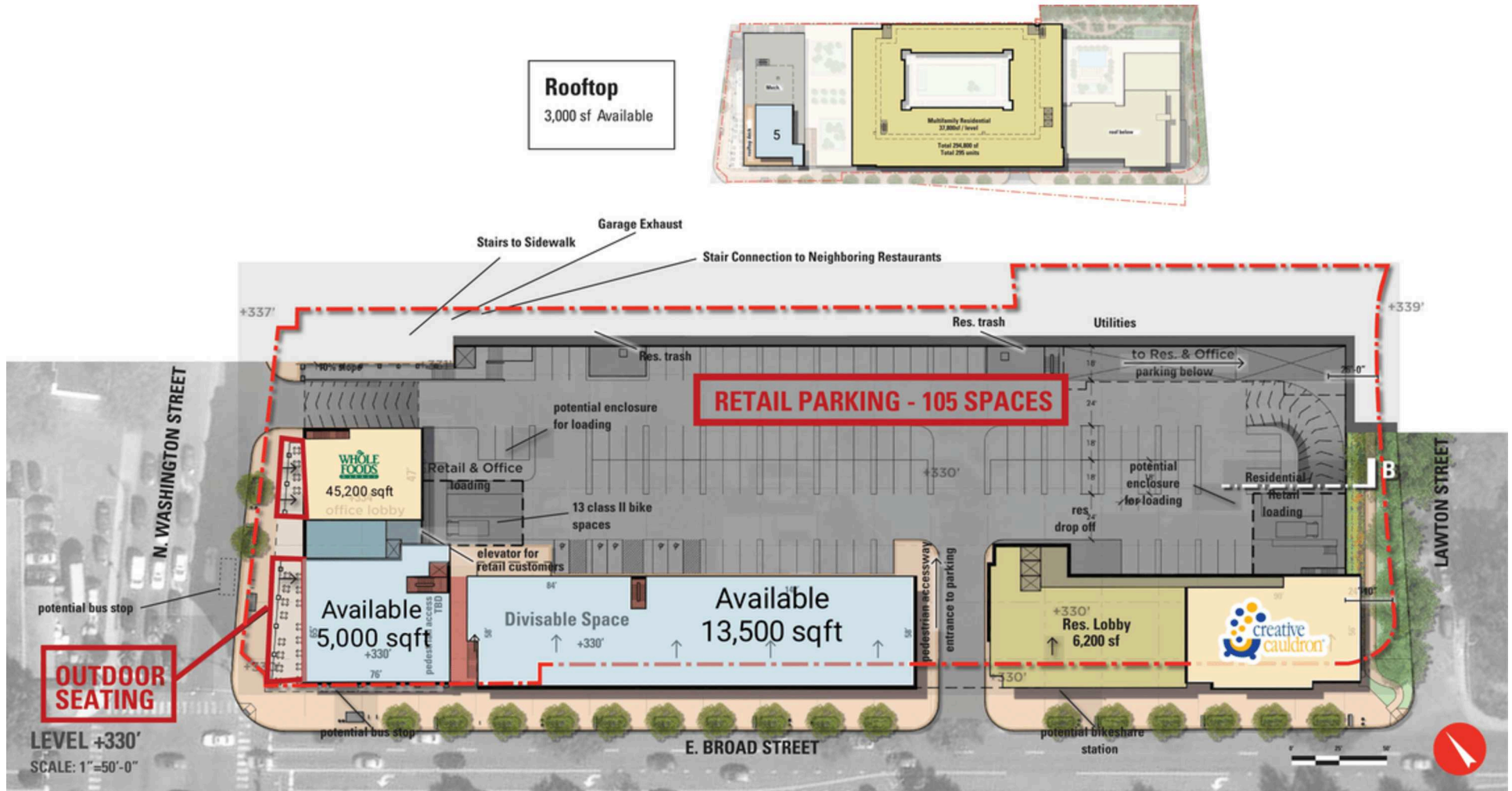

BROAD AND WASHINGTON

FALLS CHURCH, VA



RAPPAPORT

BROAD AND WASHINGTON | 100 N WASHINGTON ST, FALLS CHURCH, VA

Jim Farrell | jfarrell@rappaportco.com | 571.382.1229

rappaportco.com