

GEORGETOWN SHOPS

WASHINGTON, DC

1,436 SF AVAILABLE

RAPPAPORT







GEORGETOWN SHOPS

WASHINGTON, DC

This 13,801-square-foot open-air neighborhood center is adjacent to the 67,039-square-foot Safeway in Georgetown. The center has excellent visibility with 18,000 vehicles driving by the site daily. Georgetown Shops is strategically situated in the highly affluent north Georgetown/Glover Park neighborhood.

DEMOGRAPHICS 2024

	0.25 MILE	0.5 MILE	1 MILE
 POPULATION	1,155	6,777	33,480
 DAYTIME POPULATION	896	7,457	45,032
 HOUSEHOLD INCOME	\$215,930	\$228,598	\$198,406
 TRAFFIC COUNTS	18,000 on Wisconsin Avenue		

AREA RETAILERS



GEORGETOWN SHOPS
WASHINGTON, DC



SITE PLAN

GEORGETOWN SHOPS | WASHINGTON, DC

1,436 SF AVAILABLE

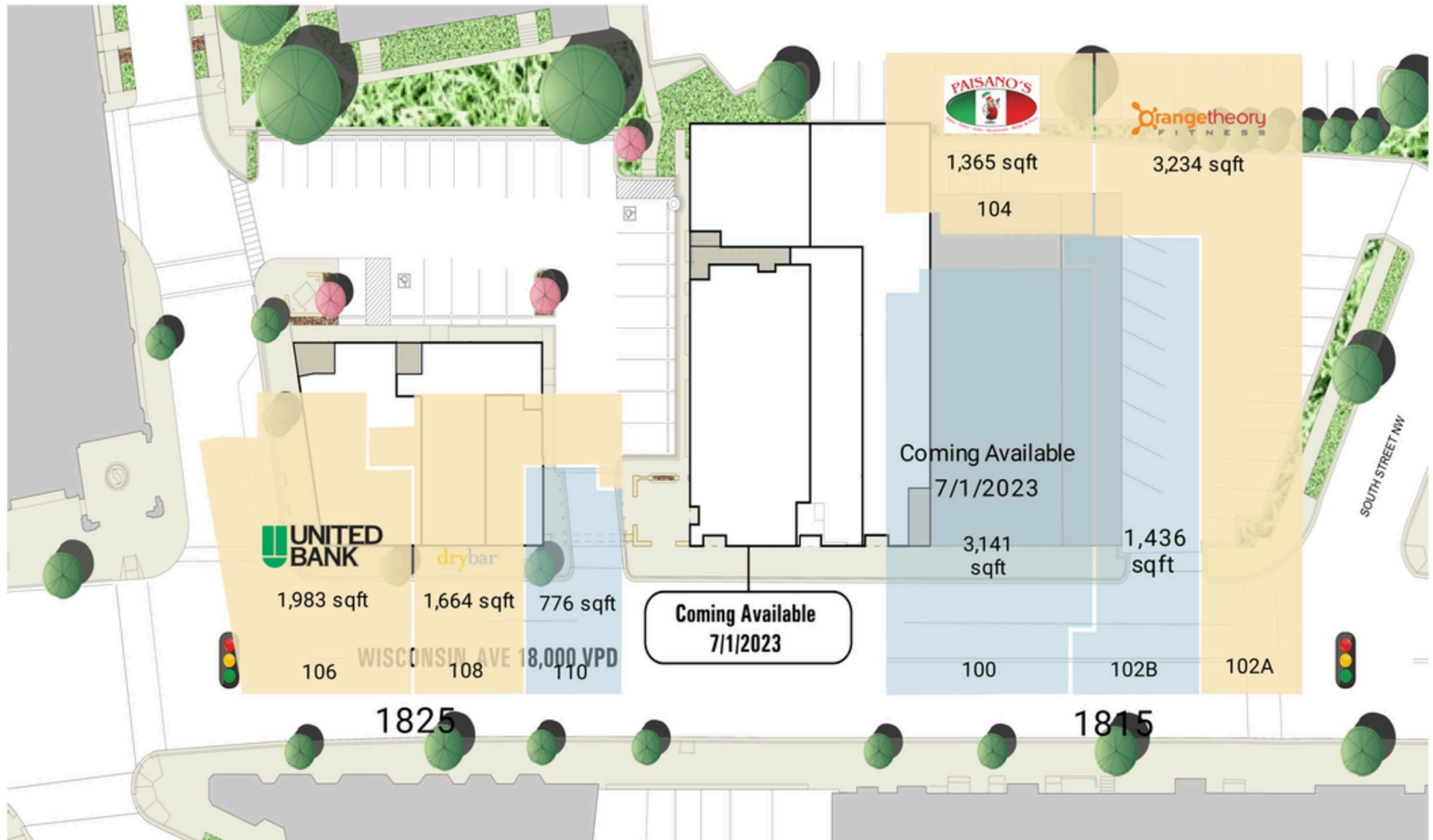

GEORGETOWN SHOPS WASHINGTON, DC



RAPPAPORT

GEORGETOWN SHOPS | 1815-1825 NORTH WISCONSIN AVE, WASHINGTON, DC

Christian Kingston | ckingston@rappaportco.com | 571.382.1255

rappaportco.com