



1310 N. COURTHOUSE RD |
Arlington, VA



Arlington, VA

Formerly a Gold’s Gym, this highly visible fitness space with over 19,000 SF offers the dense residential and daytime population in the neighborhood a convenient and walkable option to maintain their health and wellness. Located directly along N Courthouse Road, the streetfront space with ample signage will not go unnoticed to the over 9,000 vehicles passing daily. Considered a Walker’s Paradise with a 94 Walk Score, this space is surrounded by nearby employers including the Arlington General District Court, plenty of multifamily communities within walking distance, and is easily accessible to the Court House Metro Station.



2024 Demographics

	.5 mi.	1 mi.	3 mi.
Population	20,456	47,215	269,873
Daytime Population	16,121	45,325	393,344
Household Income	\$149,118	\$153,543	\$152,704
Traffic Counts	53,000 on Route 50		

Area Retailers



Arlington, VA

Formerly a Gold’s Gym, this highly visible fitness space with over 19,000 SF offers the dense residential and daytime population in the neighborhood a convenient and walkable option to maintain their health and wellness. Located directly along N Courthouse Road, the streetfront space with ample signage will not go unnoticed to the over 9,000 vehicles passing daily. Considered a Walker’s Paradise with a 94 Walk Score, this space is surrounded by nearby employers including the Arlington General District Court, plenty of multifamily communities within walking distance, and is easily accessible to the Court House Metro Station.



2024 Demographics

	.5 mi.	1 mi.	3 mi.
Population	20,456	47,215	269,873
Daytime Population	16,121	45,325	393,344
Household Income	\$149,118	\$153,543	\$152,704
Traffic Counts	53,000 on Route 50		

Area Retailers



The Area

Site Plan

● Space Available

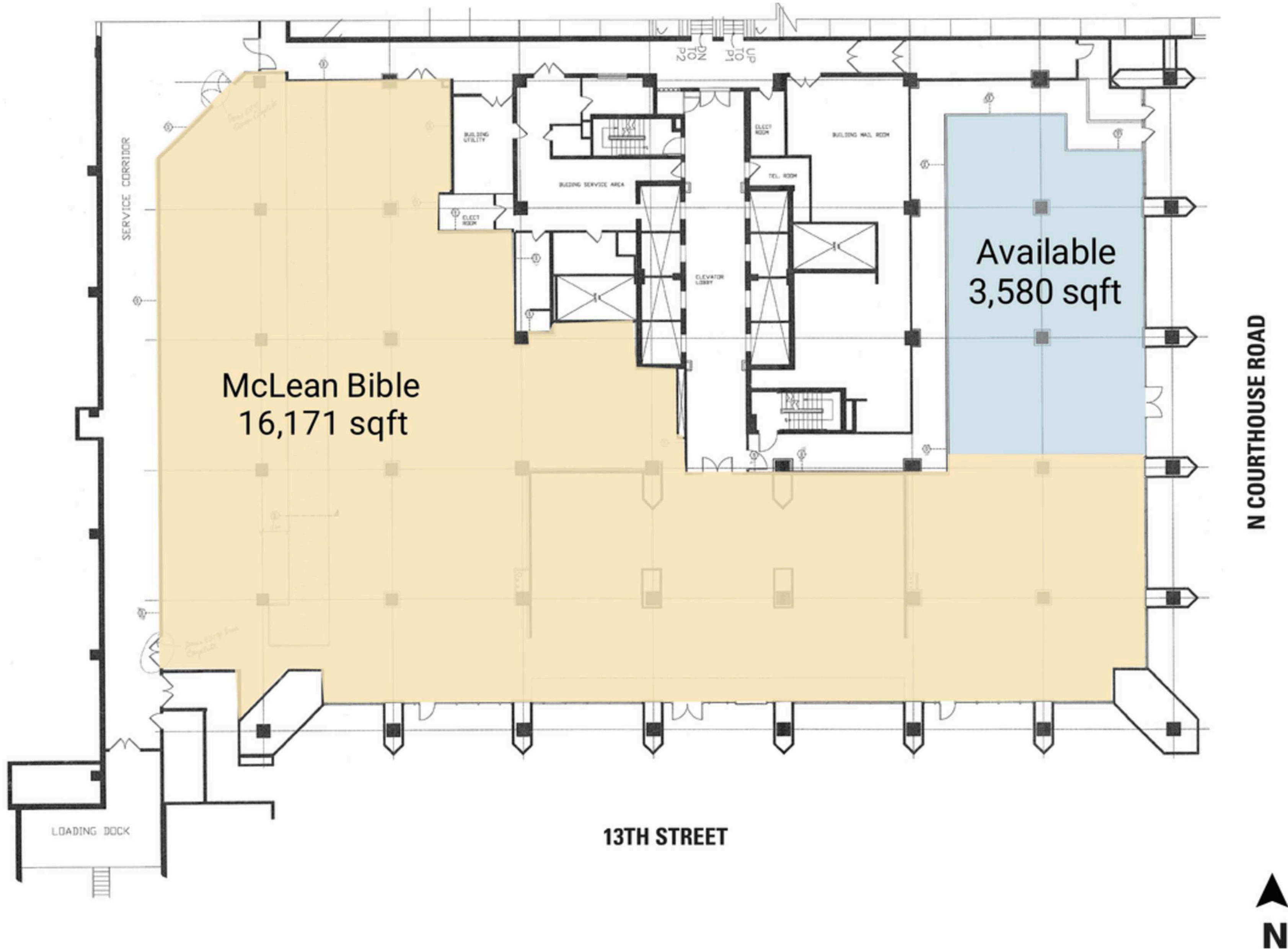

The Property



1310 N. Courthouse Rd

Discover your next retail opportunity at
rappaportco.com



WASHINGTON, D.C. | MARYLAND | VIRGINIA

1310 N. COURTHOUSE RD | 1310 N. COURTHOUSE RD, ARLINGTON, VA

Patrick O'Meara | pomeara@rappaportco.com | 571.382.1218