



BROAD AND WASHINGTON |

Falls Church, VA



Falls Church, VA

Retail space available in Downtown Falls Church's core entertainment area. Broad and Washington is an enduring mixed-use building that celebrates, showcases and supports the local cultural and community activities that make the City of Falls Church a vibrant, engaging and special place to live. The project offers exciting restaurant and retail space on the ground floor and rooftop. Join Creative Cauldron community theater in a vibrant project with ideal space for an upscale casual restaurant, bakery, specialty grocer and soft goods retailers.

2024 Demographics

	1 mi.	3 mi.	5 mi.
Population	21,694	168,806	496,171
Daytime Population	13,428	70,617	294,155
Household Income	\$167,023	\$159,141	\$145,097
Traffic Counts	26000 on Washington Street 21000 on Broad Street		

Co-Tenants



Falls Church, VA

Retail space available in Downtown Falls Church's core entertainment area. Broad and Washington is an enduring mixed-use building that celebrates, showcases and supports the local cultural and community activities that make the City of Falls Church a vibrant, engaging and special place to live. The project offers exciting restaurant and retail space on the ground floor and rooftop. Join Creative Cauldron community theater in a vibrant project with ideal space for an upscale casual restaurant, bakery, specialty grocer and soft goods retailers.



2024 Demographics

	1 mi.	3 mi.	5 mi.
Population	21,694	168,806	496,171
Daytime Population	13,428	70,617	294,155
Household Income	\$167,023	\$159,141	\$145,097
Traffic Counts	26000 on Washington Street 21000 on Broad Street		

Co-Tenants



The Area

SPACE PLAN

● Space Available

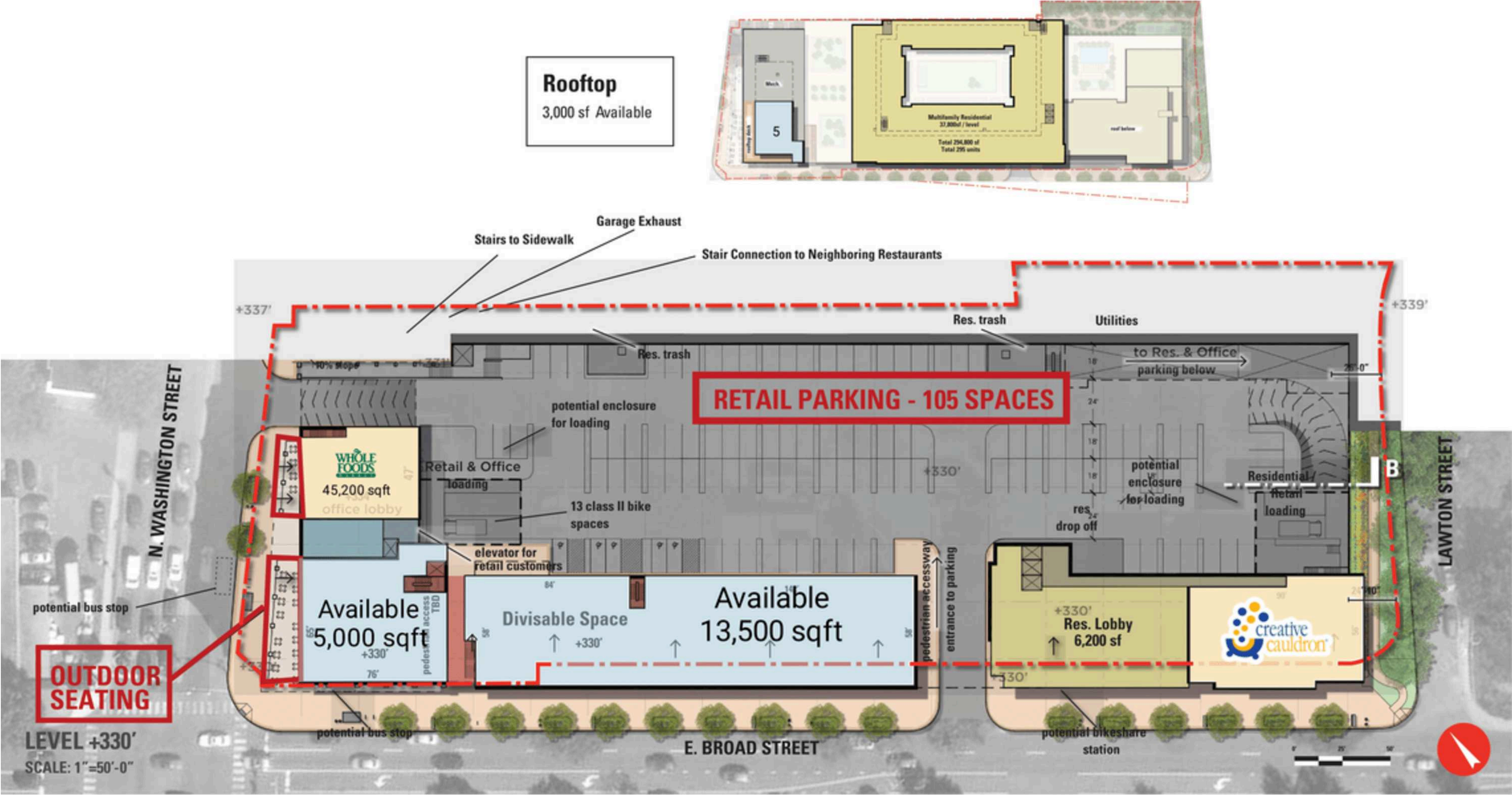

The Property



Discover your next retail opportunity at
rappaportco.com



WASHINGTON, D.C. | MARYLAND | VIRGINIA

BROAD AND WASHINGTON | 100 N WASHINGTON ST, FALLS CHURCH, VA

Jim Farrell | jfarrell@rappaportco.com | 571.382.1229