



**2121 K STREET** |  
**Washington, DC**





# Washington, DC

With a lofty 52 feet of frontage on bustling K Street, 2121 K Street NW squarely sits in the heart of Washington, D.C.'s Central Business District. The street-front retail enjoys impeccable walkability for major public- and private-sector employees, students and faculty of The George Washington University and Hospital, as well as two key Metro stations, Farragut West and Foggy Bottom-GWU (Blue, Orange, and Silver). Nestled in the high-income, highly educated city center of the district, 2121 K Street NW embodies urban convenience, access and affluence.



## 2024 Demographics

	.25 mi.	.5 mi.	1 mi.
Population	3,461	22,095	54,596
Daytime Population	52,354	157,437	363,395
Household Income	\$94,074	\$125,240	\$154,452
Traffic Counts	31,200 on K Street NW Walk Score of 98 out of 100		

## Co-Tenants





# Washington, DC

With a lofty 52 feet of frontage on bustling K Street, 2121 K Street NW squarely sits in the heart of Washington, D.C.'s Central Business District. The street-front retail enjoys impeccable walkability for major public- and private-sector employees, students and faculty of The George Washington University and Hospital, as well as two key Metro stations, Farragut West and Foggy Bottom-GWU (Blue, Orange, and Silver). Nestled in the high-income, highly educated city center of the district, 2121 K Street NW embodies urban convenience, access and affluence.

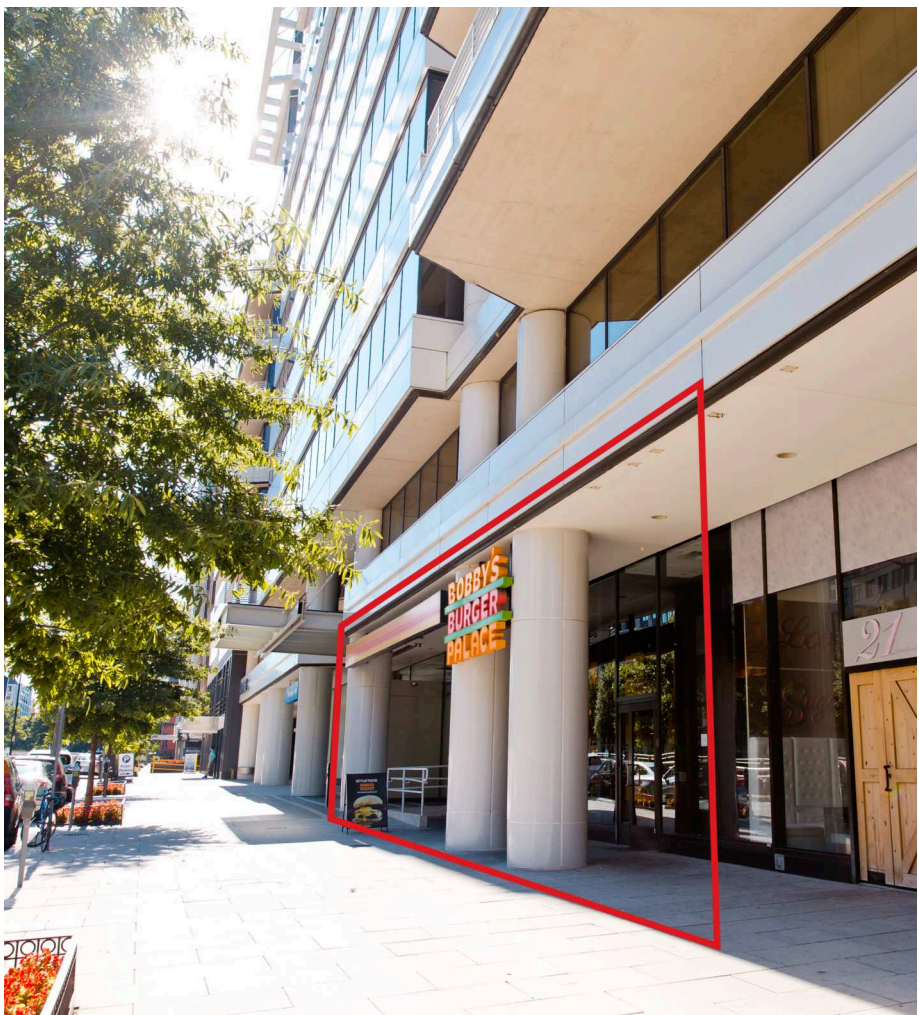

## 2024 Demographics

	.25 mi.	.5 mi.	1 mi.
Population	3,461	22,095	54,596
Daytime Population	52,354	157,437	363,395
Household Income	\$94,074	\$125,240	\$154,452
Traffic Counts	31,200 on K Street NW Walk Score of 98 out of 100		

## Co-Tenants







# The Area

# Site Plan

● Space Available

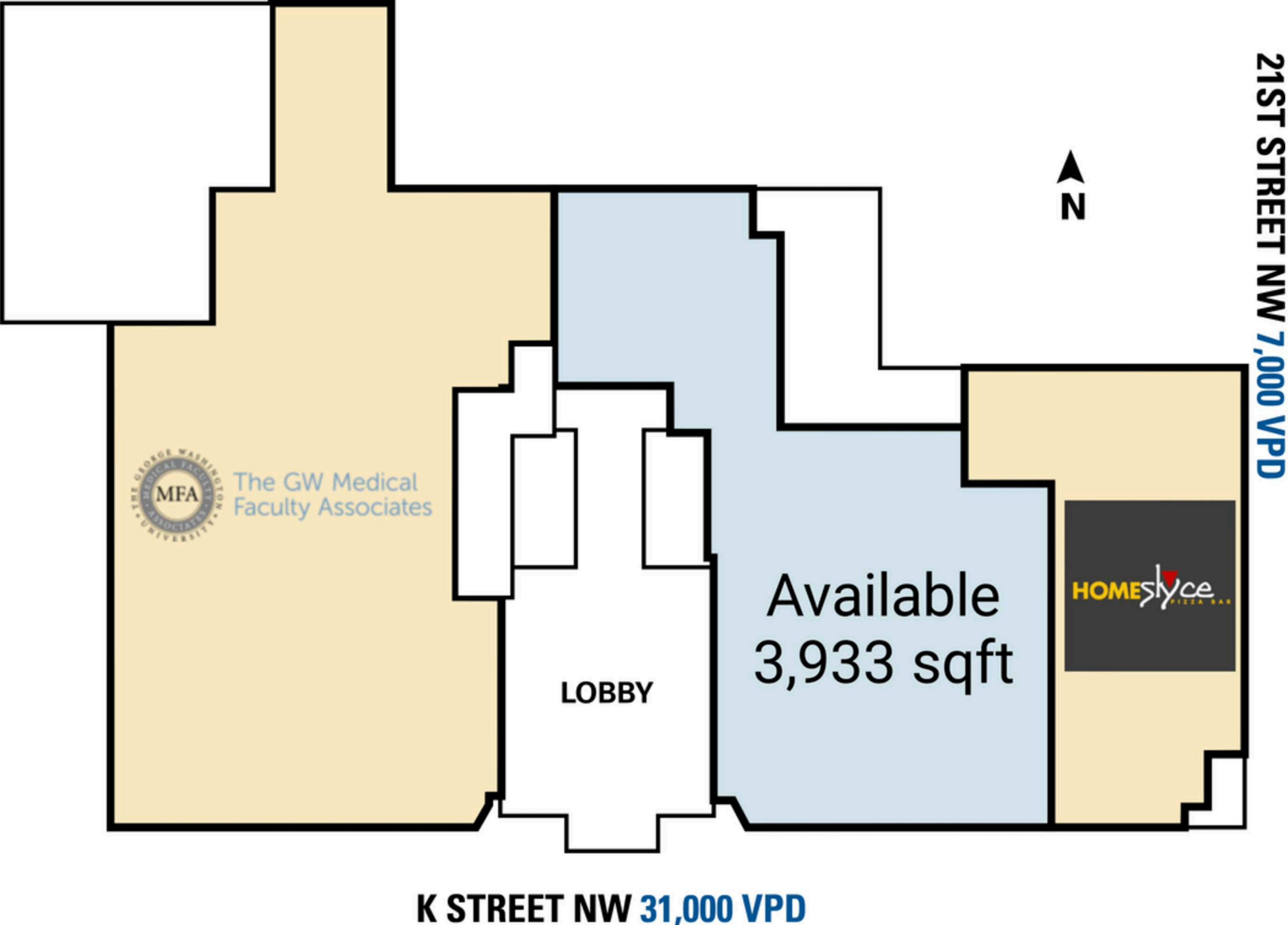



# The Property





Discover your next retail opportunity at  
**rappaportco.com**



**WASHINGTON, D.C. | MARYLAND | VIRGINIA**

**2121 K STREET | 2121 K ST NW, WASHINGTON, DC**

**Michael Howard | mhoward@rappaportco.com | 571.382.1219**