



1800 M STREET NW |
Washington, DC

RAPPAPORT
CULTIVATING PLACES

Washington, DC

Former restaurant space located on M street in DuPont’s hot fast casual trade area just south of DuPont Circle. This 6,821 SF divisible space is surrounded by almost 50 million SF of office within just half a mile of the site. The former medical space can be vented for restaurant use and has a potential outdoor patio area.



2024 Demographics

	0.25 mi.	0.5 mi.	1 mi.
Population	1,072	14,508	71,149
Daytime Population	17,320	140,074	265,710
Household Income	\$89,615	\$216,643	\$143,962
Traffic Counts	20,800 on M Street NW		

Area Retailers



Washington, DC

Former restaurant space located on M street in DuPont’s hot fast casual trade area just south of DuPont Circle. This 6,821 SF divisible space is surrounded by almost 50 million SF of office within just half a mile of the site. The former medical space can be vented for restaurant use and has a potential outdoor patio area.



2024 Demographics

	0.25 mi.	0.5 mi.	1 mi.
Population	1,072	14,508	71,149
Daytime Population	17,320	140,074	265,710
Household Income	\$89,615	\$216,643	\$143,962
Traffic Counts	20,800 on M Street NW		

Area Retailers



The Area

First Floor Retail

● Space Available

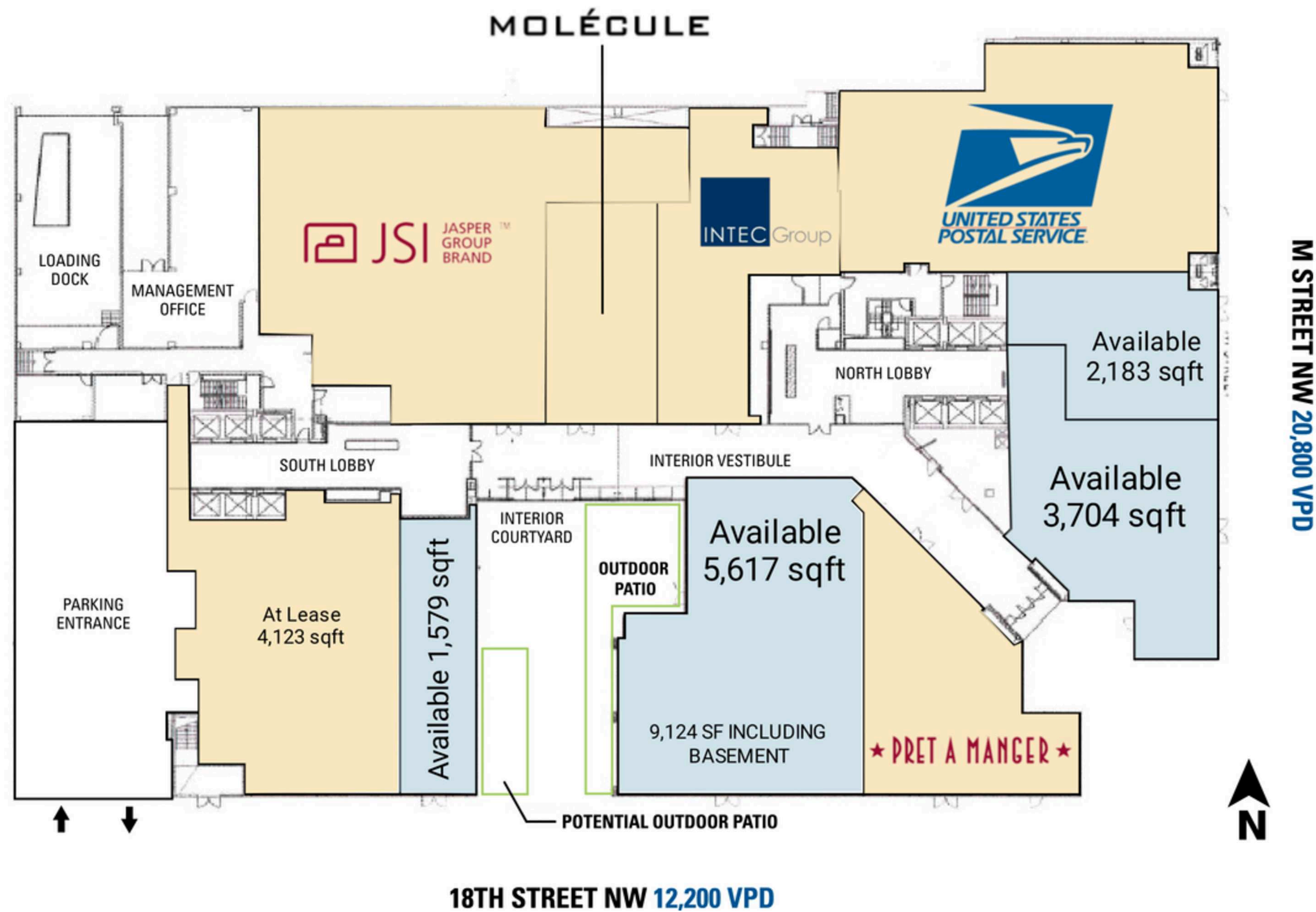

Tenant List

-	&pizza
-	Bluestone Lane
-	Cava Mezze Grill
-	Core Power Yoga
-	Nando's

-	The Palm
1	- JSI Jasper Group Brand
2	- MolÃ©cule
3	- INTEC Group
4	- USPS

5	2,183 SF	Available
6	-	Capital One
7	-	Pret a Manger
8	-	Vapiano
9	6,821 SF	Available

Lower Level Retail

● Space Available

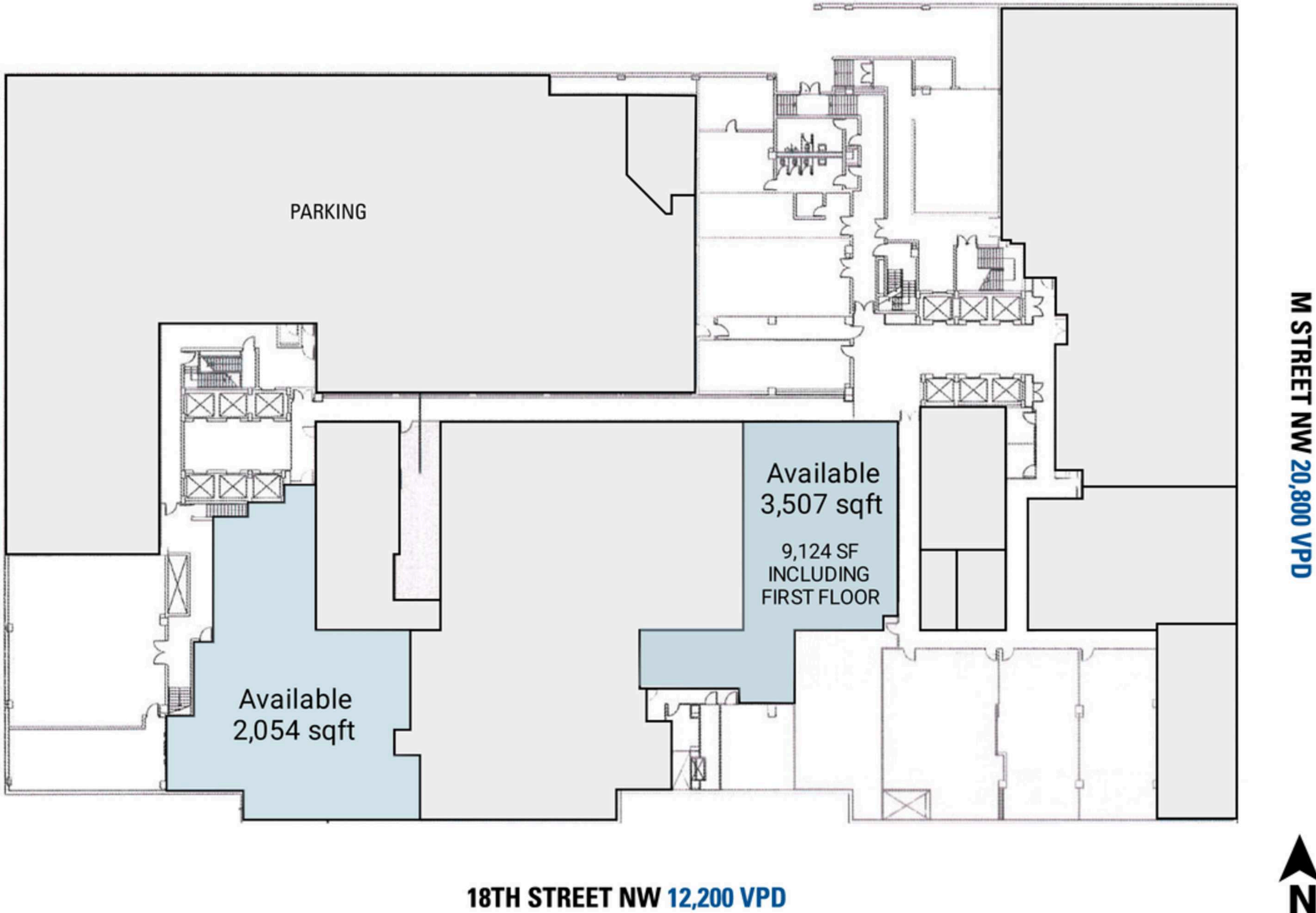

The Property



1800 M Street NW

Discover your next retail opportunity at
rappaportco.com



WASHINGTON, D.C. | MARYLAND | VIRGINIA

1800 M STREET NW | 1800 M ST NW, WASHINGTON, DC

Bill Dickinson | bdickinson@rappaportco.com | 703.310.6983