

400 11TH STREET SOUTH |
Arlington, VA



Arlington, VA

Located directly across S Eads Street from the future Amazon HQ2 in Arlington, this building is catty-corner from Whole Foods, and a short walk from the Pentagon City Metro Station. 400 11th Street South is destined for high visibility and lots of pedestrian traffic as the new Amazon headquarters breaks ground and then opens in the next couple years. Just off the intersection of I-395 and US-1 in the heart of Pentagon City, this is a place with incredible proximity to Washington D.C.



2024 Demographics

	1 mi.	3 mi.	5 mi.
Population	22,852	216,884	816,981
Daytime Population	42,718	678,543	1,390,606
Household Income	\$152,948	\$145,090	\$137,640
Traffic Counts	9,100 on S Eads Street 145,000 on I-395		

Area Retailers



Arlington, VA

Located directly across S Eads Street from the future Amazon HQ2 in Arlington, this building is catty-corner from Whole Foods, and a short walk from the Pentagon City Metro Station. 400 11th Street South is destined for high visibility and lots of pedestrian traffic as the new Amazon headquarters breaks ground and then opens in the next couple years. Just off the intersection of I-395 and US-1 in the heart of Pentagon City, this is a place with incredible proximity to Washington D.C.



2024 Demographics

	1 mi.	3 mi.	5 mi.
Population	22,852	216,884	816,981
Daytime Population	42,718	678,543	1,390,606
Household Income	\$152,948	\$145,090	\$137,640
Traffic Counts	9,100 on S Eads Street 145,000 on I-395		

Area Retailers



The Area

Site Plan

● Space Available

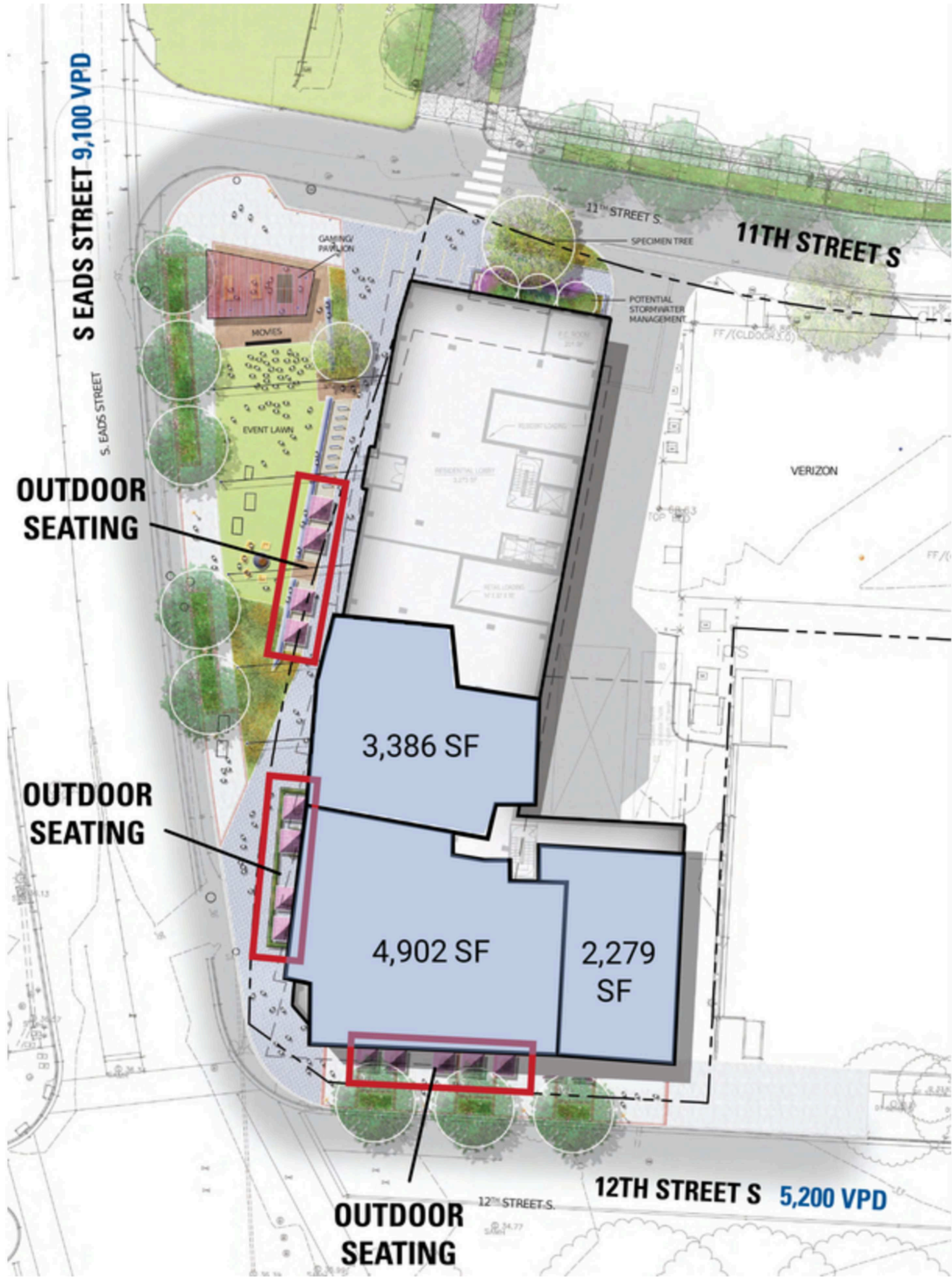

The Property



400 11th Street South

Discover your next retail opportunity at
rappaportco.com



WASHINGTON, D.C. | MARYLAND | VIRGINIA

400 11TH STREET SOUTH | 400 11TH STREET SOUTH, ARLINGTON, VA

Patrick O'Meara | pomeara@rappaportco.com | 571.382.1218